

DATE: Thursday, December 12, 2019
 FILE: N:\Garver USA\180094 Travis Co Linden Rd Drainage Impr\000\20-Drawings\Plans\Civil\180094 LINDEN RD DETOUR

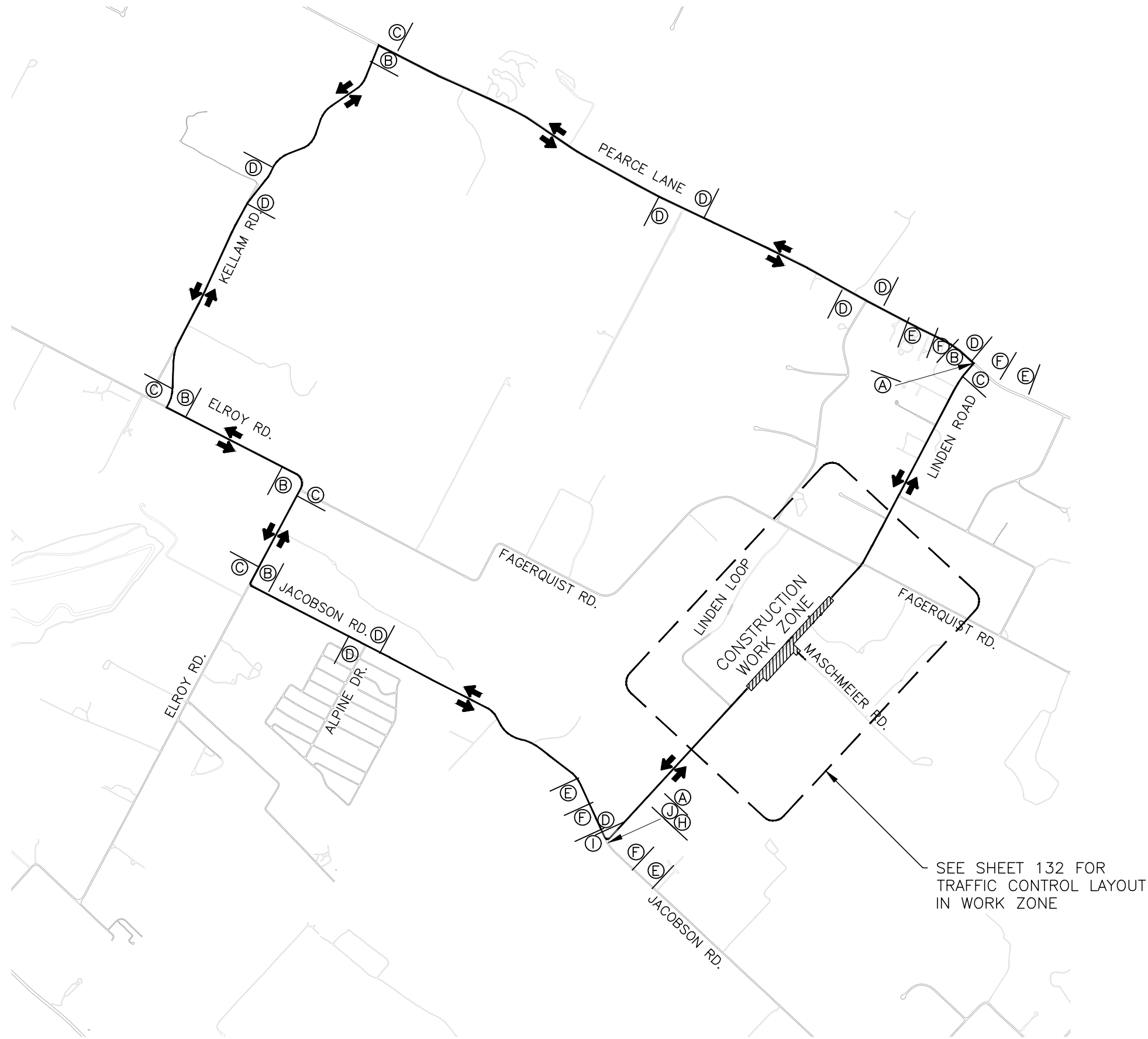

SEE SHEET 132 FOR
 TRAFFIC CONTROL LAYOUT
 IN WORK ZONE

1 LINDEN ROAD DETOUR TRAFFIC CONTROL PLAN
 SCALE: 1" = 2000'

LEGEND	
	DETOUR ROUTE
A -	STATIC MESSAGE BOARD: LINDEN ROAD CLOSED AHEAD FOLLOW DETOUR
B -	M4-9N 30"x12" M4-9AR 30"x30"
C -	M4-9N 30"x12" M4-9AL 30"x30"
D -	M4-9N 30"x12" M4-9S 30"x24"
E -	C3RDXD 48"x48" M4-9N 30"x12"
F -	C3RDXD 48"x48" M4-9N 30"x12"
G -	R11-2 48"x30"
H -	R11-3A 60"x30"
I -	M4-8a 24"x18"
J -	TYPE III BARRICADE *SEE TxDOT STD. DETAIL WZ (RD) - 13 FOR PLACEMENT GUIDELINES

TRAVIS COUNTY, TEXAS
 TRANSPORTATION AND NATURAL
 RESOURCES DEPARTMENT

MAILING ADDRESS:
 P.O. BOX 1748
 AUSTIN, TEXAS 78767
 (512) 854-9383

CONTRACT #
 IFB#
 PRECINCT: 4

SCALE: 1" = 2000'

GARVER

DRAWN BY: JTS
 DESIGN BY: JMS
 TITLE: LINDEN RD. AT MAHA CREEK
 LINDEN ROAD
 DETOUR TRAFFIC
 CONTROL PLAN

STATE OF TEXAS
 JAMES M. SASSIN
 61417
 LICENSED PROFESSIONAL ENGINEER

DATE: 12/12/2019

REV.	DATE	DESCRIPTION	BY

SHEET NO. 131
 OF 187

engineers | architects | surveyors
 7500 RIALTO BLVD., BUILDING 1
 SUITE 240, AUSTIN, TX 78735
 PH. (512) 381-8333
 WWW.LNVINC.COM

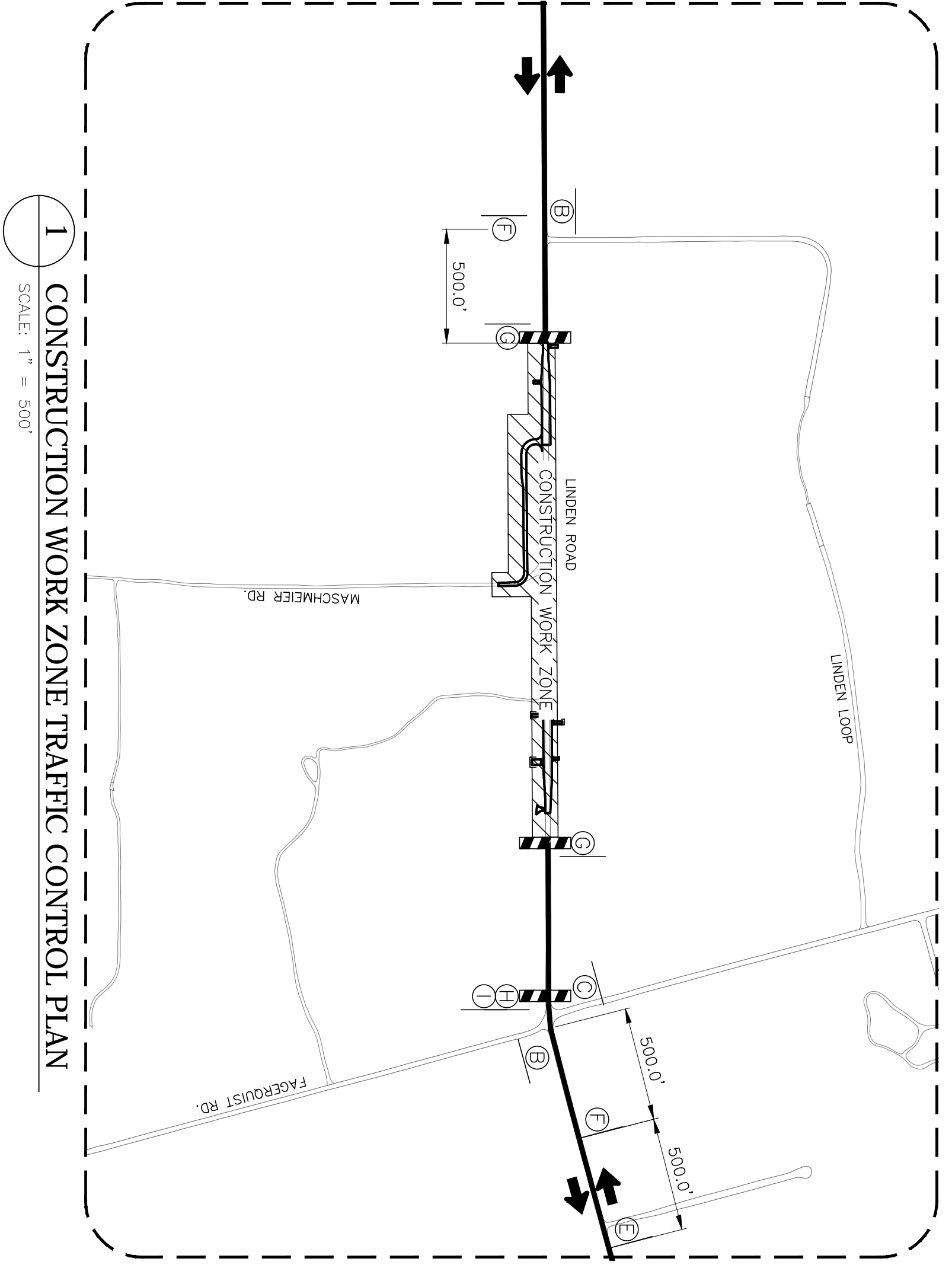

1 CONSTRUCTION WORK ZONE TRAFFIC CONTROL PLAN

SCALE: 1" = 500'

LEGEND

- ↔ - DETOUR ROUTE
- A - STATIC MESSAGE BOARD:
LINDEN ROAD CLOSED -
AHEAD FOLLOW DETOUR
- B - LINDEN ROAD DETOUR
M4-9N
50' x12'
M4-9AR
30' x30'
- C - LINDEN ROAD DETOUR
M4-9N
50' x12'
M4-9AL
30' x30'
- D - LINDEN ROAD DETOUR
M4-9N
50' x12'
M4-9S
30' x24'
- E - ROAD CLOSED (1000 FT)
LINDEN ROAD
CW20-3B
48' x48'
M4-9N
30' x12'
- F - ROAD CLOSED (300 FT)
LINDEN ROAD
CW20-3C
48' x48'
M4-9N
30' x12'
- G - ROAD CLOSED
R11-2
48' x30'
- H - ROAD CLOSED (LOCAL TRAFFIC ONLY)
R11-2A
60' x30'
- I - END DETOUR
M4-9S
24' x18'
- J - TYPE III BARRICADE
SEE PROJECT STD. DETAIL
PLACEMENT GUIDELINES

LNV
 engineers | architects | surveyors

7500 DUALTO BLVD., BUILDING 1
 SUITE 240, AUSTIN, TX 78735
 WWW.LNVINC.COM

TBPE FIRM NO. F-3466
 TBPL S FIRM NO. 10128501
 PH. (512) 381-8333

REV.	DATE	DESCRIPTION	BY

DATE: 12/12/2019

SHEET NO. 132 OF 187

DRAWN BY: JTS
 DESIGN BY: JMS
 TITLE: LINDEN RD. AT MAHA CREEK CONSTRUCTION WORK ZONE TRAFFIC CONTROL PLAN

GARVER

CONTRACT#
 IFB#
 PRECINCT: 4

0 250' 500'
 SCALE: 1" = 500'

TRAVIS COUNTY, TEXAS
 TRANSPORTATION AND NATURAL
 RESOURCES DEPARTMENT

MAILING ADDRESS:
 P.O. BOX 1748
 AUSTIN, TEXAS 78767

PUBLIC WORKS
 DESIGN

(512) 854-9383