



10/4  
**Travis County Commissioners Court Agenda Request**

**Meeting Date:** October 15, 2013

**Prepared By:** David Greear, Engineer Senior **Phone #:** (512) 854-7650

**Division Director/Manager:** Donald W. Ward, P.E., Assistant Public Works  
Director of Road and Bridge Maintenance

*Carol B. Greear for*  
**Department Head:** Steven M. Manilla, P.E., County Executive-TNR

**Sponsoring Court Member:** Commissioner Gomez, Precinct Four

**AGENDA LANGUAGE:** Consider and take appropriate action on the approval of contraflow operations on Pearce Lane from Ross Road to Kellam Road with regards to post event traffic operations of the Formula One Grand Prix November 15-17, 2013 in Precinct Four.

**BACKGROUND/SUMMARY OF REQUEST:**

Circuit of the Americas (CoTA) has submitted a transportation plan for the 2013 Formula One Grand Prix that summarizes their approach for getting 120,000 spectators to and from the race. The plan includes different modes and routes of transportation including the use of contraflow operations on Pearce Lane. Post event on November 15th, 16th, and 17th, CoTA plans to utilize both lanes on Pearce Lane and send all traffic westbound from Kellam Road to Ross Road from 12:00 pm to 7:00 pm. All traffic control set-up and traffic control officers will be the responsibility of CoTA. See attached traffic control plans in the back-up materials.

**STAFF RECOMMENDATIONS:**

TNR staff recommends approval of contraflow operations.

**ISSUES AND OPPORTUNITIES:**

N/A

**FISCAL IMPACT AND SOURCE OF FUNDING:**

All costs for developing and implementing the Transportation Plan are borne by CoTA.

**ATTACHMENTS/EXHIBITS:**

Transportation Plan  
Affidavit of Posting

**REQUIRED AUTHORIZATIONS:**

Cynthia McDonald	Financial Manager	TNR	(512) 854-4239
Steven M. Manilla	County Executive	TNR	(512) 854-9429
ESD #11			(512) 243-3477
Michael Hemby	Planning Manager	TCSO	(512) 854-9770
Dispatch		TCSO	(512) 974-0845 + 3
Stephanie Jensen	Public Safety GIS	COA	(512) 974-6446

**CC:**

**DG:DW:dg**

**4101 - Road, Bridge, Fleet Svs - AI Formula One Grand Prix Pearce Lane.**

## WORK REQUEST FORM

Routing & Check off				
Responsible.	Item	DATE	INIT.	
Dispatch	WRF Nos. 274942	9-16	CMC	
Greear	WRF Delivered to SMS			
Garcia	Work Completed			
Greear	Update Database			

<b>Date:</b>	9/16/13
<b>Staff Contact:</b>	David Greear 512-854-7650
<b>Requestor Name</b>	
<b>Request Category:</b>	4115 – Signs
<b>General Location (Pct #):</b>	4
<b>Facility ID (Rd. Index No.)</b>	E09400 (Pearce Lane)
<b>Priority / Requested completion date</b>	RO - Routine
<b>Short Description (street name &amp; work type):</b>	Pearce Lane – Public Hearing Signage
<b>Detailed Description:</b>	
<ul style="list-style-type: none"> <li>Install two "Notice of Public Hearing" signs on Pearce Lane per following sketch. Signs must be in place by Friday, September 20, 2013.</li> <li>Remove the signs after Public Hearing and action on <b>October 15, 2013</b>.</li> </ul>	

Qty.	Sign No.	Size	Description/Text
2			Notice of Public Hearing

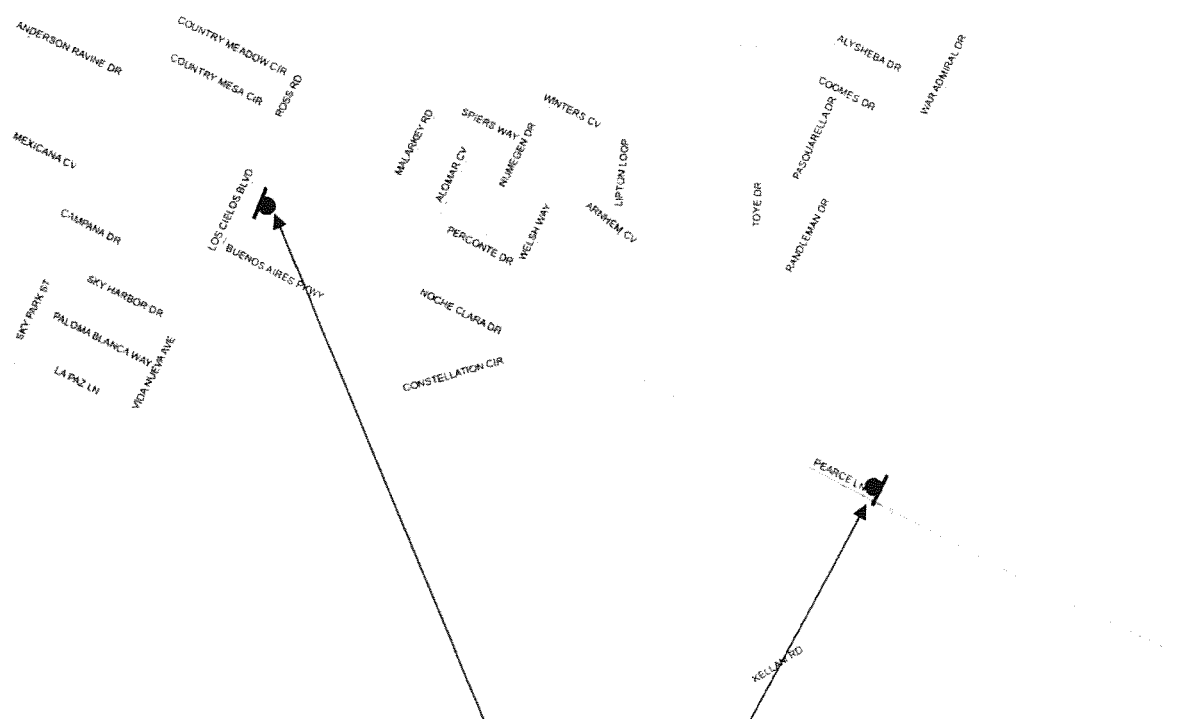

# NOTICE OF PUBLIC HEARING

OCTOBER 15, 2013 AT 9:00 AM.

CONCERNING CONTRA-FLOW OPERATIONS  
ON PEARCE LANE FOR THE  
FORMULA ONE GRAND PRIX  
NOVEMBER 15-17, 2013

AT THE TRAVIS COUNTY  
COMMISSIONERS COURTROOM  
700 LAVACA STREET  
(FIRST FLOOR), AUSTIN, TX

FOR ADDITIONAL INFORMATION CALL 512-854-7650



**TRANSPORTATION AND NATURAL RESOURCES**

STEVEN M. MANILLA, P.E., County Executive  
700 Lavaca Street  
P.O. Box 1748  
Austin, Texas 78767  
tel: 512-854-9383  
fax: 512-854-4649

**AFFIDAVIT OF POSTING**

**TO: County Judge  
County Commissioners  
Travis County, Texas**

Public notices of Public Hearing for Contra-Flow Operations were posted on

September 18, 2013 at TWO locations on PEARCE LANE,

this location being as near as practical to the area being affected.

CERTIFIED THIS THE 18 DAY OF September 2013.  
(date) (month)

SIGNATURE: Jaime Garcia  
NAME (print): Jaime Garcia  
TITLE: TNR/R&B Supervisor

Public Notice sign posted on Westbound Pearce Lane just west of Kellam Road.



Public Notice sign posted on Eastbound Pearce Lane just east of Ross Road.



# DRAFT 9.19.2013

Plotted By: Arcadis, Sotilego, Sheet Set: KHA - Layout: Post\_1 - September 19, 2013 09:46:55am. K:\AUS\_IP10\069229101 - C:\TA\F1\2013\CADD\Sheets\Sheets\_Used\Conceptual\_Trip\_4\_3.dwg  
This document, together with the concepts and designs presented herein, is an instrument of service, it is intended and to be used for the specific purpose and of use for which it was prepared. It is not to be used for any other purpose without the written authorization and approval of Kimley-Horn and Associates, Inc. Any use for other than the specific purpose and of use for which it was prepared is unauthorized and constitutes a violation of the professional seal of Kimley-Horn and Associates, Inc.

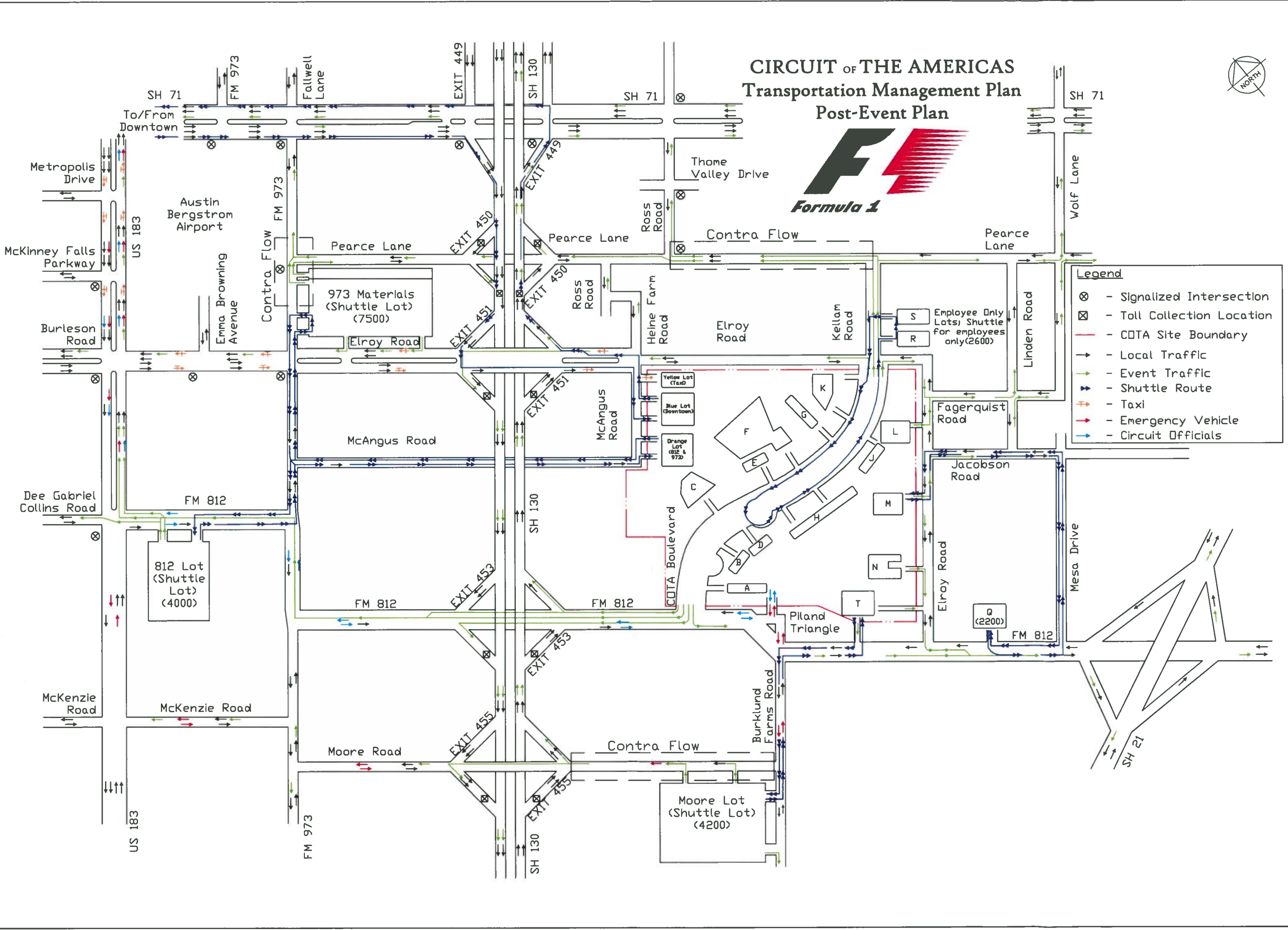

<b>POST-EVENT TRAFFIC CONTROL PLAN</b> <small>PREPARED FOR</small>  <small>AUSTIN TEXAS</small>	<b>POST-EVENT SCHEMATIC</b> 	 <small>© 2013 KIMLEY-HORN AND ASSOCIATES, INC.          17750 WERT DRIVE, SUITE 1000, DALLAS, TX 75251          PHONE: 972-770-1300 FAX: 972-238-3870          WWW.KIMLEY-HORN.COM TX F-928</small>	<table border="1" style="width: 100%; border-collapse: collapse;"> <tr> <td style="font-size: x-small;">KHA PROJECT 069229101</td> <td style="font-size: x-small;">DATE SEPT. 2013</td> <td style="font-size: x-small;">SCALE AS SHOWN</td> <td style="font-size: x-small;">DESIGNED BY AWM</td> <td style="font-size: x-small;">DRAWN BY SAA</td> <td style="font-size: x-small;">CHECKED BY KHA</td> </tr> </table>	KHA PROJECT 069229101	DATE SEPT. 2013	SCALE AS SHOWN	DESIGNED BY AWM	DRAWN BY SAA	CHECKED BY KHA	<table border="1" style="width: 100%; border-collapse: collapse;"> <tr> <td style="font-size: x-small;">No.</td> <td style="font-size: x-small;">REVISIONS</td> <td style="font-size: x-small;">DATE</td> <td style="font-size: x-small;">BY</td> </tr> <tr> <td> </td> <td> </td> <td> </td> <td> </td> </tr> </table>	No.	REVISIONS	DATE	BY				
KHA PROJECT 069229101	DATE SEPT. 2013	SCALE AS SHOWN	DESIGNED BY AWM	DRAWN BY SAA	CHECKED BY KHA													
No.	REVISIONS	DATE	BY															

# DRAFT 9.19.2013

Plotted By: Aroque, Santiago - Sheet Set: KHA - Layout: Pre-1 - September 19, 2013 - 09:46:25am - K:\AUS\_TPTD\069229101 - C:\AUS\_TPTD\069229101 - Conceptual - TWP\_4\_5.dwg  
 This document, together with the concepts and design presented herein, is intended only for the specific purpose and client for which it was prepared. Reuse of and/or reliance on this document without written authorization and approval by Kimley-Horn and Associates, Inc. shall be without liability to Kimley-Horn and Associates, Inc.

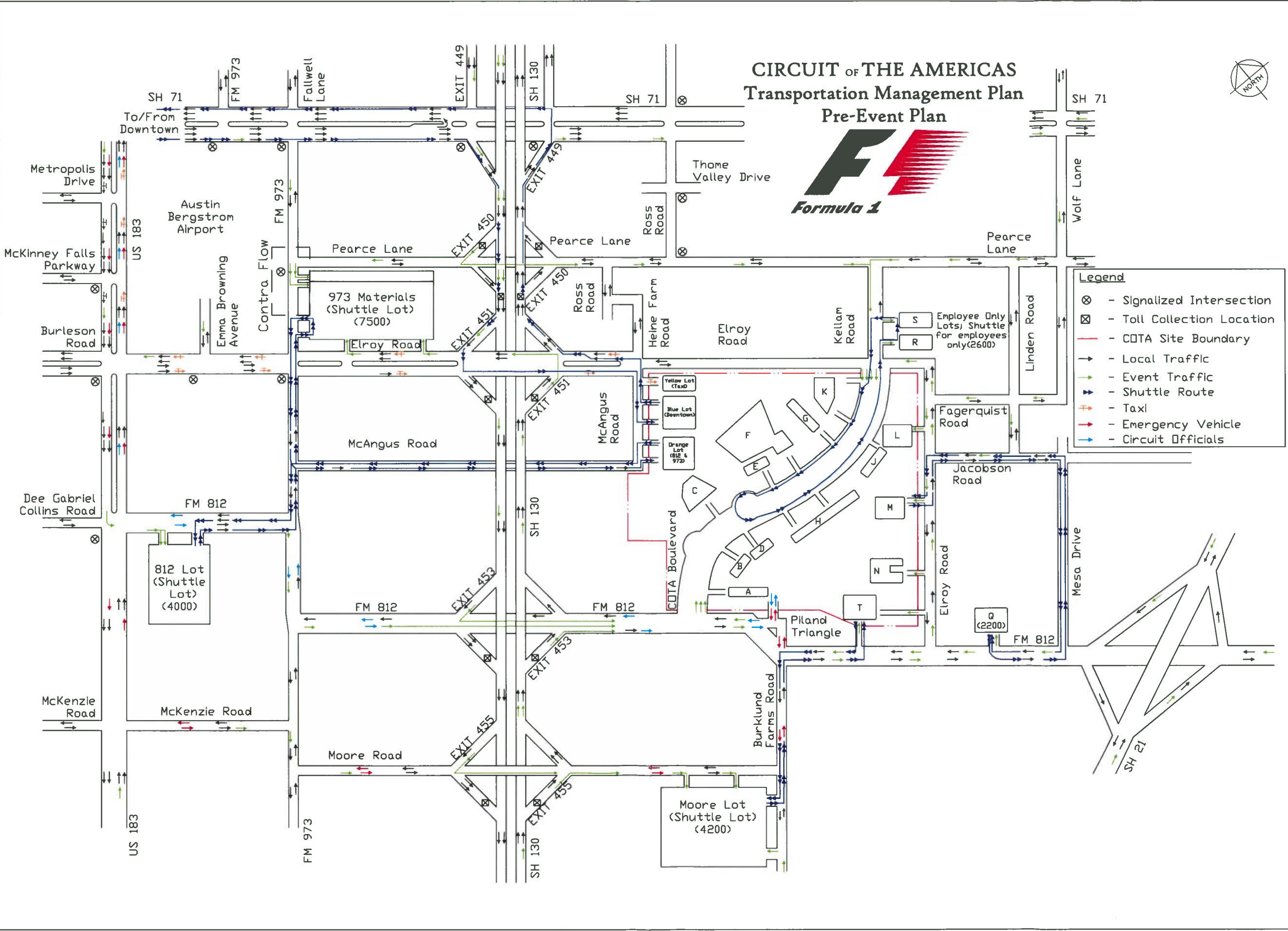

 <b>Kimley-Horn and Associates, Inc.</b> <small>© 2012 KIMLEY-HORN AND ASSOCIATES, INC.        13752 VALLEY-HORN DRIVE, SUITE 1000, BOCA RATON, FL 33431        PHONE: 972-776-1300 FAX: 972-236-3820        WWW.KIMLEY-HORN.COM TX F-928</small>	 <small>PROFESSIONAL ENGINEER        AARON M. NATHAN        No. 06953 - Exp. 07/31/13</small>	<small>KHA PROJECT        069229101        DATE        SEPT. 2013        SCALE AS SHOWN        DESIGNED BY AVN        DRAWN BY SAA        CHECKED BY KHA</small>	<b>PRE-EVENT SCHEMATIC</b> 	<b>PRE-EVENT TRAFFIC CONTROL PLAN</b> <small>PREPARED FOR</small> 
SHEET NUMBER	4	AUSTIN, TEXAS	REVISIONS	DATE