



Item C4

## Travis County Commissioners Court Agenda Request

**Meeting Date:** 10/2/12

**Prepared By/Phone Number:** David Greear, P.E. (854-7650)

**Division Director/Manager:** Donald W. Ward, P.E., Division Director, Road Maintenance and Fleet Services

**Department Head:** Steven M. Manilla, P.E., County Executive-TNR

**Sponsoring Court Member:** Commissioner Eckhardt, Precinct Two

**AGENDA LANGUAGE:** Approve the setting of a public hearing on October 16, 2012 to receive comments regarding a request to close Bullick Hollow Road nightly (9:00pm thru 6:00am, Sunday thru Thursday) between RM 620 and Oasis Bluff Drive from October 29, 2012 to May 31, 2013 in Precinct Two.

### **BACKGROUND/SUMMARY OF REQUEST AND ATTACHMENTS:**

The City of Austin in conjunction with the construction of Water Treatment Plant #4, has scheduled improvements that consist of the construction of an electrical ductbank along Bullick Hollow Road from RM 620 to Oasis Bluff Drive.

The City anticipates a 7 month construction period with road closures from October 2012 to May 2013. Excavation will consist of a trench 10-12 feet in width along the ductbank alignment and several wider, 18 ft portions of the trench for the ductbank manholes with no more than 200 linear feet of trench open at one time. Road closures to thru traffic will be at nighttime only (Sunday thru Thursday), from 9:00 PM to 6:00 AM, with an emergency access lane maintained at all times. Detours will be managed with signage and programmable electronic sign boards as detailed in the Detour Plan included in the attached Traffic Control Plan sheets. At the end of each night shift, texturized steel plates (and support members) will be welded and pinned into place over any open excavations and daytime traffic flow of one lane in either direction will be maintained. All local traffic will still have access during construction.

### **STAFF RECOMMENDATIONS:**

Staff recommends that Bullick Hollow Road between RM 620 and Oasis Bluff Drive be closed to through traffic nightly from October 29, 2012 through May 31, 2013 or until construction is completed.

### **ISSUES AND OPPORTUNITIES:**

N/A

**FISCAL IMPACT AND SOURCE OF FUNDING:**

This closure will require some work by Travis County road maintenance crews to post public notices, all detour signage will be installed by the contractor.

**REQUIRED AUTHORIZATIONS:**

Cynthia McDonald	Financial Manager	TNR	854-4239
Steve Manilla	County Executive	TNR	854-9429

**CC:**

Don Ward, TNR (854-9317)	ESD # 4 836-7566	Stephanie Jensen COA Public Safety GIS, (974-6446)	
David Greear, TNR (854-7650)	ESD # 6 266-2533	TCSO Dispatch (974-0845 +3)	
Howard Herrin, TNR (266-3314)			

: :  
**0801 - NREQ -**

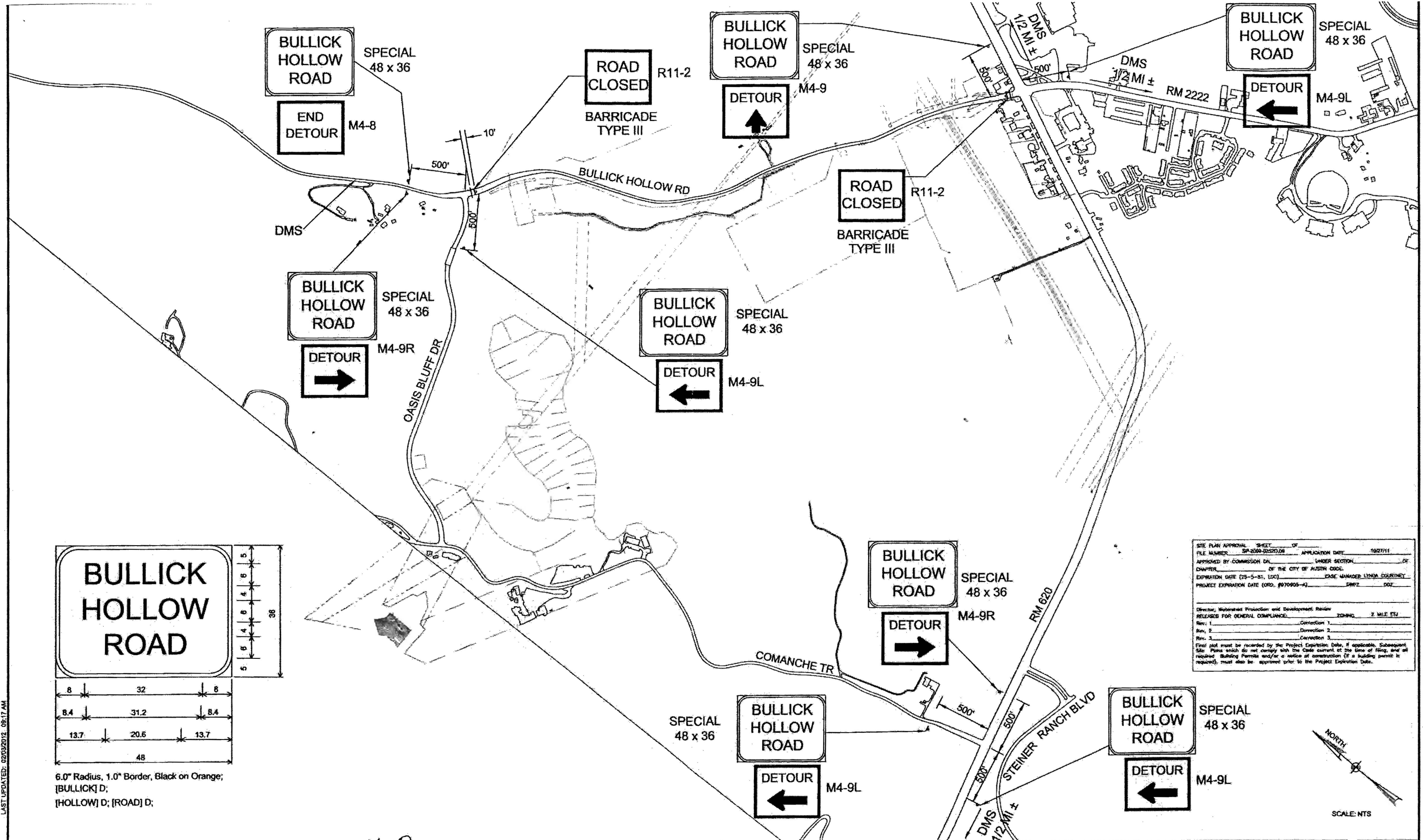

SITE PLAN APPROVAL SHEET OF		APPLICATION DATE	10/27/11
FILE NUMBER	SP-2010-02573.08	UNDER SECTION	
APPROVED BY COMMISSIONER OR		OF THE CITY OF AUSTIN CODE	
CHAPTER		CASE MANAGER	LYNDA COURTNEY
EXPIRATION DATE (25-5-31, LDC)		PROJECT EXPIRATION DATE (ORD. #070905-1)	08/22 002
Director, Watershed Protection and Development Review			
RELEASED FOR GENERAL COMPLIANCE: ZDHWG 2 MLE ETX			
Rev. 1	Correction 1		
Rev. 2	Correction 2		
Rev. 3	Correction 3		
Final plan must be recorded by the Project Expiration Date, if applicable. Subsequent Site Plans which do not comply with the Code current at the time of filing, and all required Building Permits and/or a notice of construction (if a building permit is required), must also be approved prior to the Project Expiration Date.			

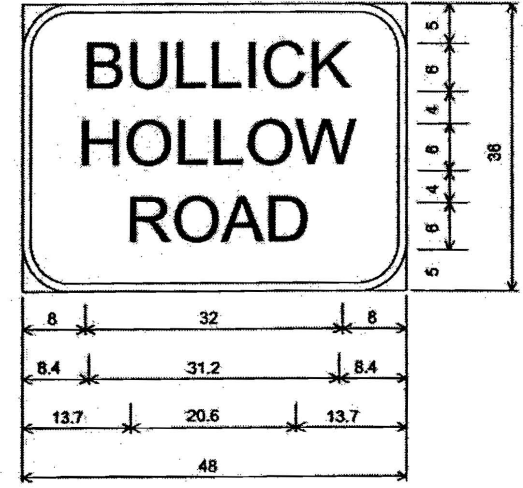

6.0" Radius, 1.0" Border, Black on Orange;  
 [BULLICK] D;  
 [HOLLOW] D; [ROAD] D;

LAST UPDATED: 02/03/2012 09:17 AM  
 LAST SAVED BY: groms

REV	DATE	BY	DESCRIPTION

DESIGNED  
BEE

DRAWN  
JNTG

CHECKED  
MR

DATE  
FEBRUARY 2012

**AECOM**

AECOM TECHNICAL SERVICES INC.  
 400 W 15th STREET SUITE 500  
 AUSTIN, TEXAS 78701  
 WWW.AECOM.COM  
 TBE REG. NO. F-3580

**Carollo**

Engineers...Working Wonders With Water™

FIRM REGISTRATION NO. F-882

**CITY OF AUSTIN**

WATER TREATMENT PLANT NO. 4

WTP 4 - BULLICK HOLLOW ROAD DUCTBANK

CIVIL

TRAFFIC CONTROL PLAN  
DETOUR PLAN

VERIFY SCALES  
 BAR IS ONE INCH ON ORIGINAL DRAWING  
 0 1" = 100'  
 IF NOT ONE INCH ON THIS SHEET, ADJUST SCALES ACCORDINGLY

JOB NO. 6460H.10  
 DRAWING NO. 7C-00-G23B  
 SHEET NO. 23 OF 57